

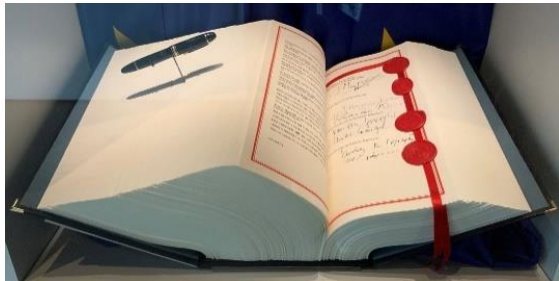

# Welcome to Maastricht

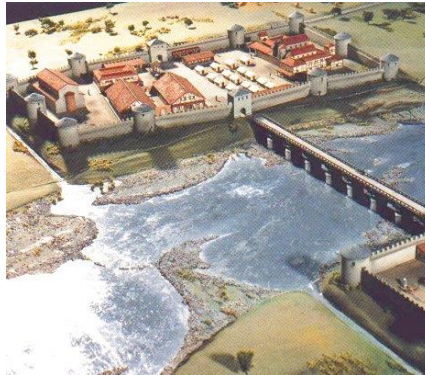

- Maastricht is the capital and largest city of Limburg province in the Netherlands that borders Belgium and Germany
  - Meuse-Rhine Euroregion with Aachen (Germany), Liège and Hasselt (Belgium)
- Population: app. 122k.
- History of over 2000 years back to Roman times
  - Traiectum ad Mosam: "ford in the Meuse river"
- Maastricht Treaty agreement
  - Foundation treaty EU
  - Birthplace of EURO as a single European currency.

# Maastricht Sightseeing

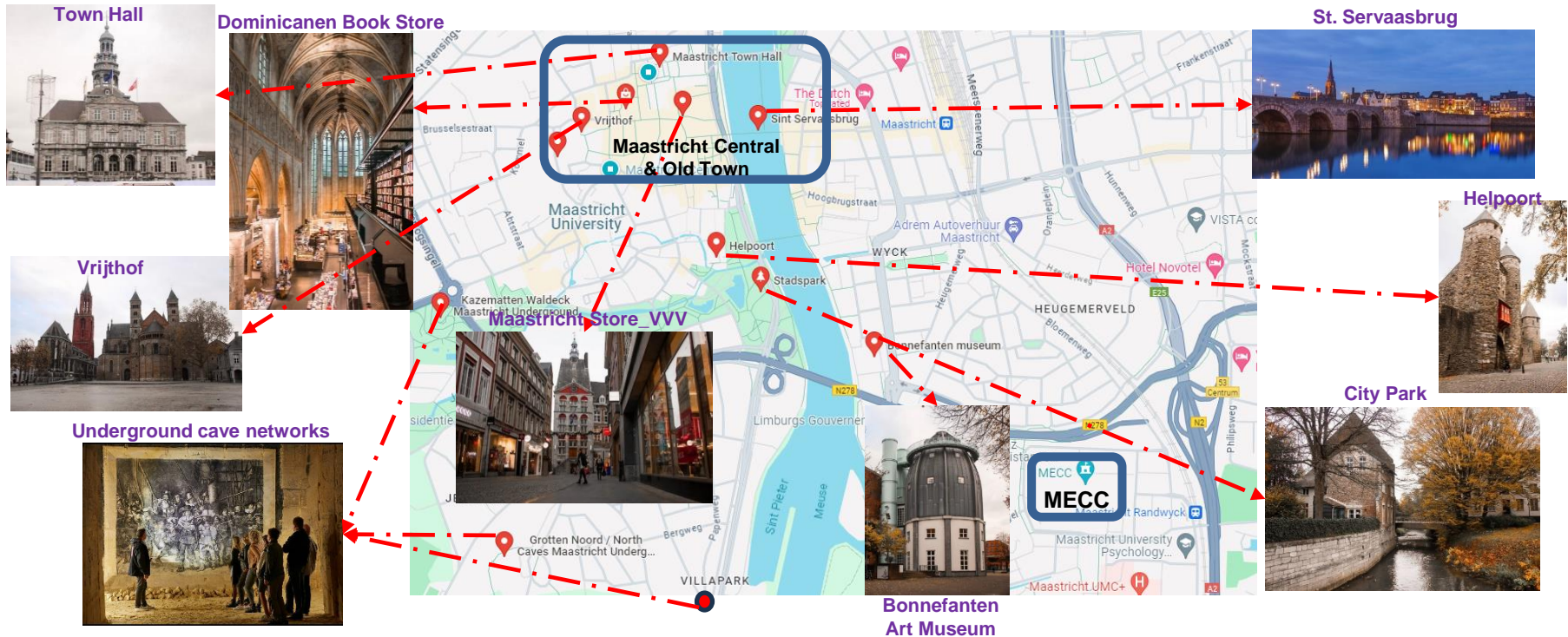

- **Vrijthof** is the location of
  - famous Maastricht-born violinist conductor André Rieu's annual summer concert
  - the biggest food festival in the Netherlands since 1982, Preuvenemint, with more than 50 restaurants and music



# Public transport and how to reach MECC

Multiple transport companies, e.g.:

- NS (train)
  - to **Maastricht-Randwyck station** (5 minutes walk to MECC)
- Arriva (train, bus, <https://www.arriva.nl/>)
  - **bus stop** for the MECC: '**Forum MECC**', line 7
  - On average one bus every 5 minutes from Maastricht center or Maastricht Central (station) to MECC
- Plan your journey with <https://9292.nl/>
- All accept OV-Pay (country-wide): you can use your
  - (Foreign) Mastercard or VISA credit cards
  - (Foreign) Maestro or V-Pay debit cardsto pay for your journey **without getting a separate ticket**
- You just '**check in**' (touch) on entering and '**check out**' (touch again) on exiting; your statement will show the charges



# Parking your car at MECC

- Parking for one day costs €19.00 euros.
- You can order your parking ticket in advance using this link [MECC Maastricht Parkeren](#)
- If you have an electric car please register in advance with [claire.gauthier@etsi.org](mailto:claire.gauthier@etsi.org) or [emmanuelle.wurffel@etsi.org](mailto:emmanuelle.wurffel@etsi.org). You will be directed to another parking lot so you can charge your car there.



MECC opening/closing  
time

**07:30-20:30**

**No access on Sunday**



# 3GPP network and External FTP access

**Wireless LAN:**

SSID: 3GPPWIFI

Password: 3GPP3GPPM (CAPITAL LETTERS!)

**Access to Server:**

IP address: 10.10.10.10

**Local subnet**

10.10.0.0 **/19 (size increased)**

Address for external FTP access, already available:  
[maastrichtmecc.3gpp.org](ftp://maastrichtmecc.3gpp.org)

Reminder:

3gppmeeting

RemoteAccess2Docs





# Meeting access control and Hospitality Desk

## Registration and badge

**When entering the meeting venue, please make sure that you have your QR code available (either on paper or on your mobile phone)**

**On our first day of meeting, please scan your QR code on the self-printing desk located at the 3GPP hospitality desk & self printing badge, Forum passage Left and Forum passage Right, level 1 (see the 2 yellow desks and badge areas in the floor plan on the next slide)**

**We are here to help you**

[emmanuelle.wurffel@etsi.org](mailto:emmanuelle.wurffel@etsi.org) or

+33 4 92 94 4266

(line forwarded to mobile phone)

[claire.gauthier@etsi.org](mailto:claire.gauthier@etsi.org) or

+33 4 92 94 4322

(line forwarded to mobile phone)

[jean-luc.freisse@etsi.org](mailto:jean-luc.freisse@etsi.org) & [aldric.hiegel@etsi.org](mailto:aldric.hiegel@etsi.org)

(IT)

**Please wear your badge all week.  
Your badge will be scanned regularly by our hostesses  
(from Monday PM).**



# Hospitality desks/badge areas (level 1)

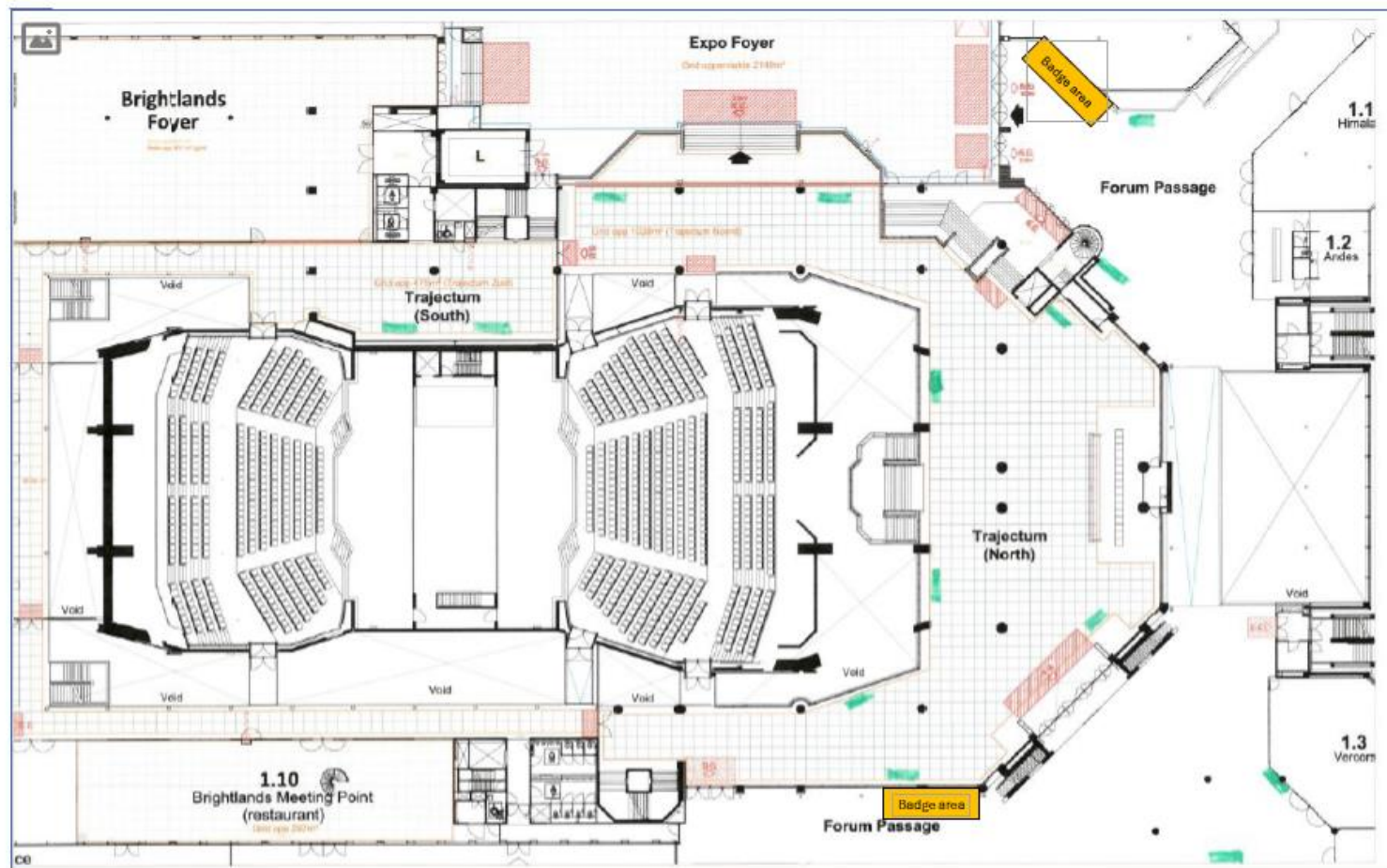





# Meeting rooms

## RAN1 meetings Monday-Friday

- **Expo Foyer (level 1)**: **3GPP RAN1#118** for 500 people –
  - Breakout rooms:
    - (0.4 Brussels - 120 pax)
    - (2.18/2.19 Mekiong/Madeira - 120 pax)
    - (0.8 Rome - 60 pax)
    - (Praetorium, level 0 - 177 pax)



# Coffee breaks

**10:30-11:00**

**15:30-17:00**

**(except on Friday PM)**

Where:

**Lobby, level 0**

**Trajectum & Forum, level 1**

(see floor plans in the next slides)

# Room plan level 0

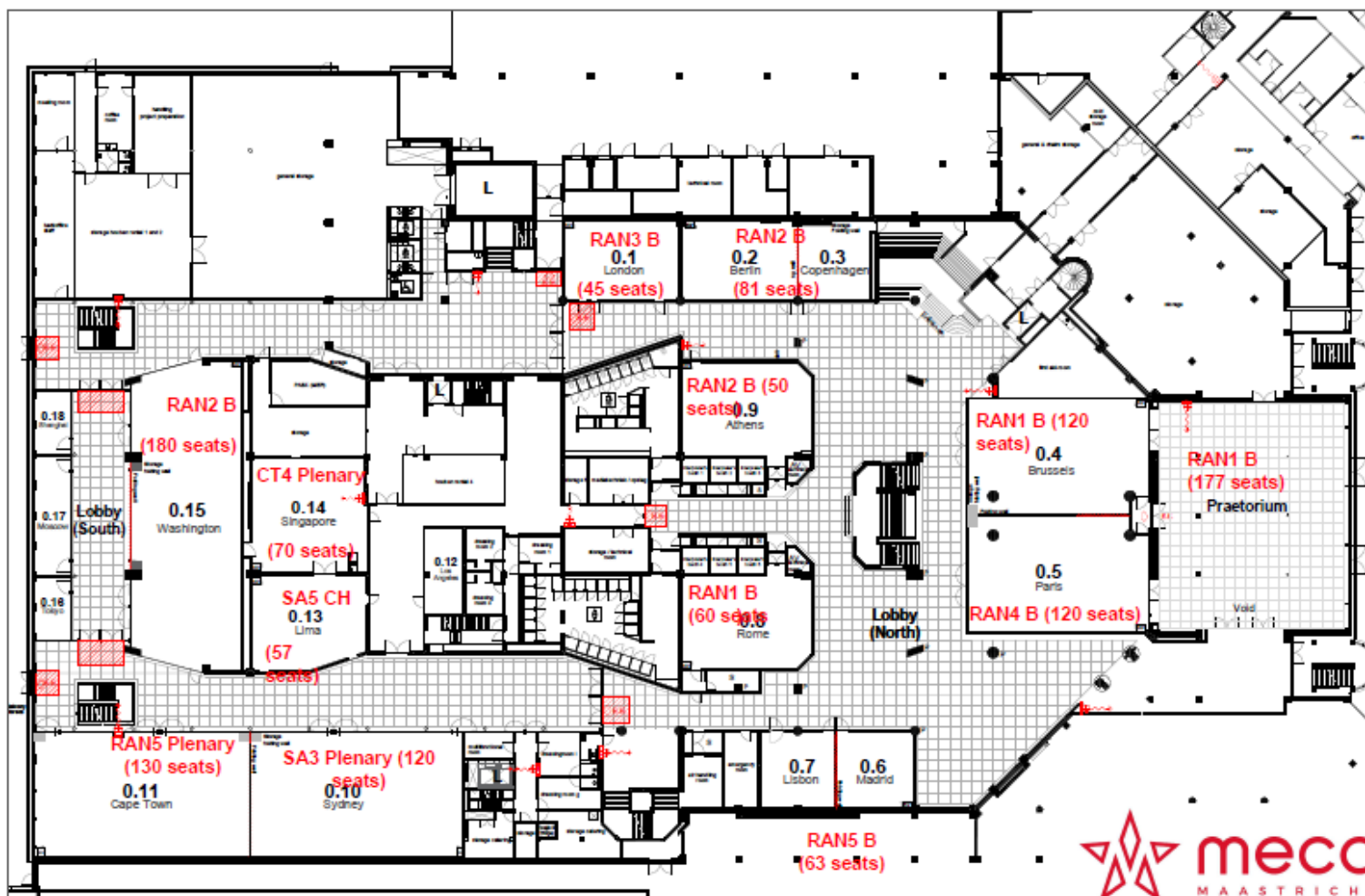

# Room plan level 1

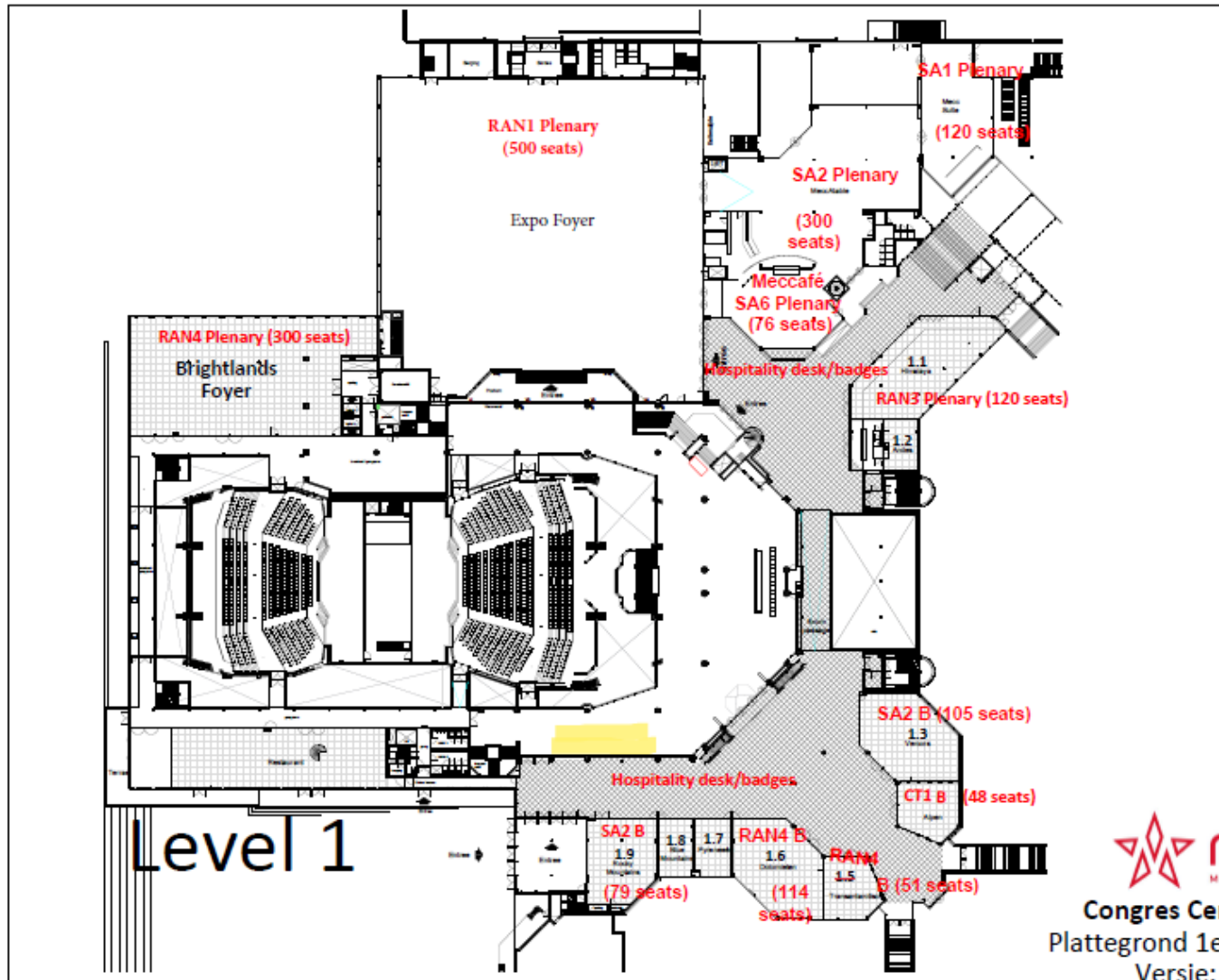

# Room plan level 2

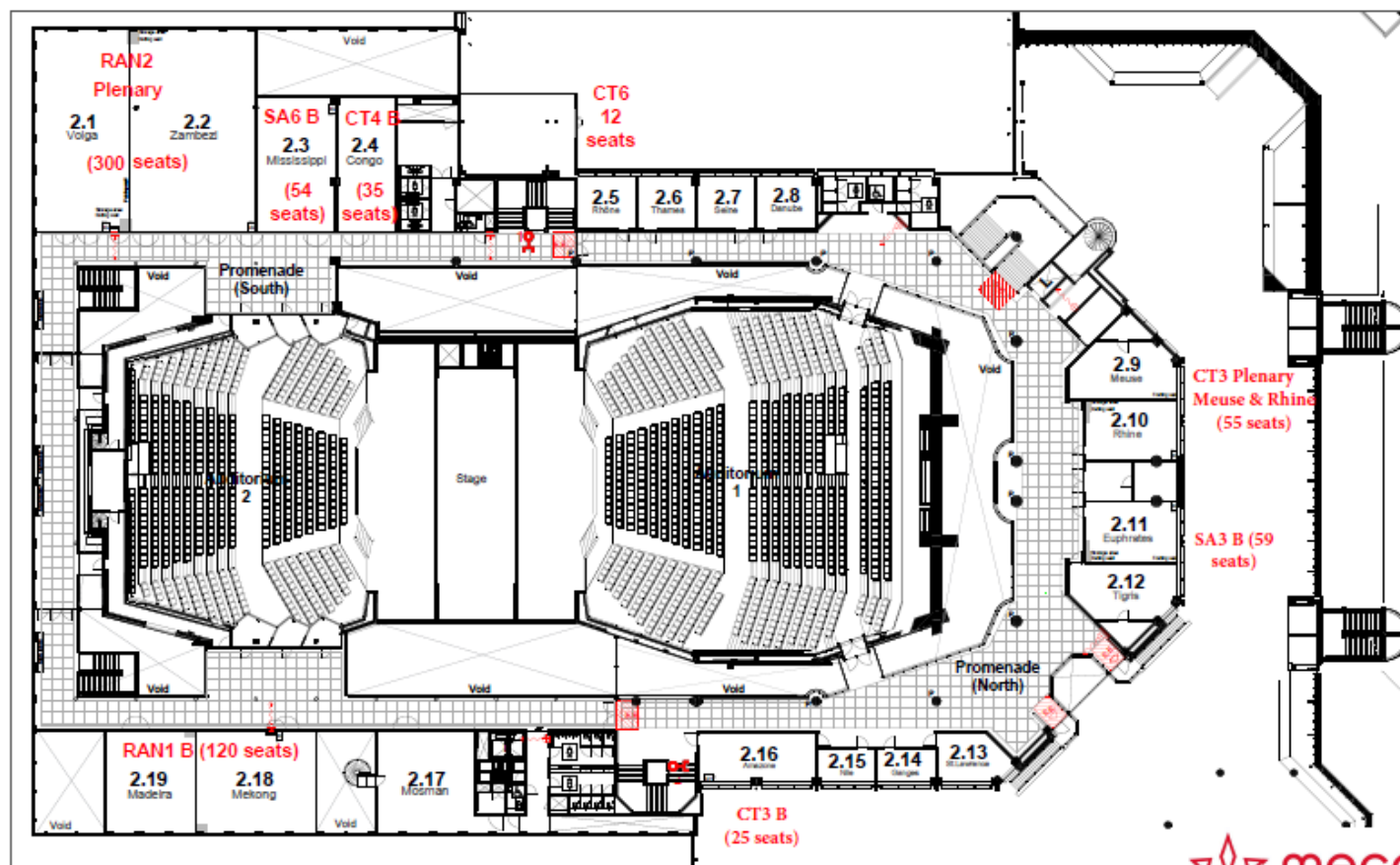

Disclaimer: Aan deze tekeningen kunnen geen rechten worden ontleend. De werkelijke situatie kan afwijken van de tekening. Alle maten moeten nog worden gecontroleerd na oplevering bouw.





# 3GPP coffee stations on level 0 (in green)





# 3GPP coffee stations on level 1 (in green)

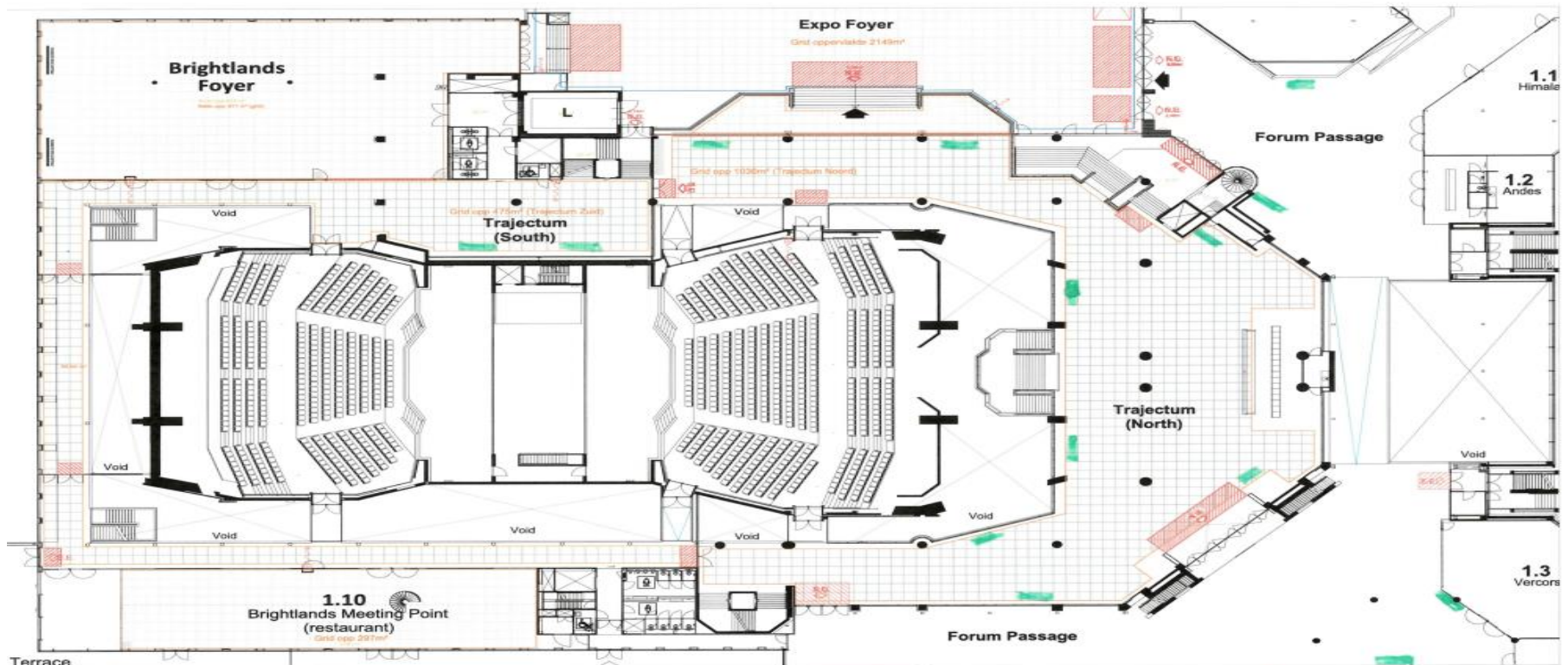

**Congress Centre 2020**  
**Plattegrond Nivo 1 - Oppervlaktes**  
Versie: 27-10-2020



# Lunch

**Lunch will be served from 11.30 – 14.15\***

- Indoor snacking area \*

(corridor of the congress center,  
tables & chairs available on the square in front of MECC)

- Sam Restaurant \*

- NH restaurant

# Restaurants and Cuisine

The “mega meeting” slide deck available on the server provides suggestions within walking distance from MECC or downtown (Maastricht center)

## Local/Dutch delicacies/specialties

- **Rijsttafel** – "rice table", a shared feast:



- **Bitterballen** – “deep fried meat-based snack”:



- **Zoervleis** - “sour beef/horse stew”



- **Poffertjes** - “dutch pancake bites”





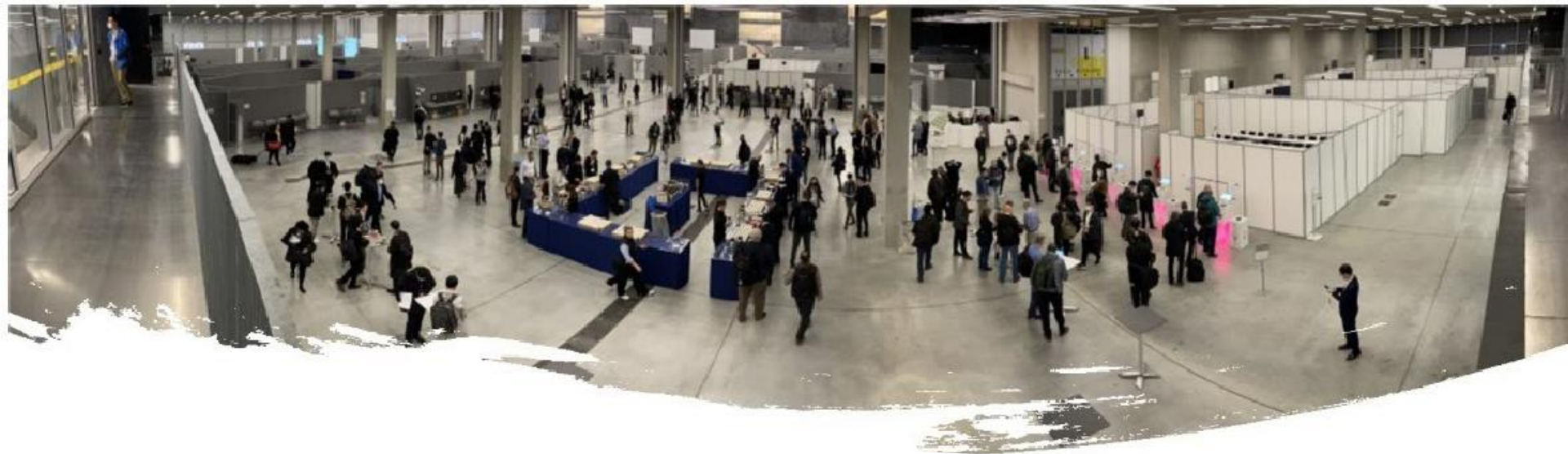

Have a great time in Maastricht!



[E3MAG@etsi.org](mailto:E3MAG@etsi.org)