



ETSI has the pleasure of welcoming you to Gothia Towers, Goteborg
3GPP RAN WGs
from Monday 9 to Friday 13 February 2026



New 3GPP EU meetings web site

3GPP EU meeting web site





Live chat during the
meeting

3GPP EU meeting web site



Welcome to Sweden



The Olympic Games have just started



Don't be surprised to see Swedes checking scores during coffee breaks

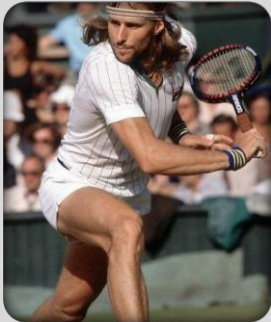

Swedes really enjoy sports — it's part of everyday life



Göteborgsvarvet

Gothenburg hosts the world's largest half marathon



Gothia Cup – the world's largest youth football tournament, uniting young players from more than 70 countries in Gothenburg every summer.



The lovely Swedish Summer and Winter
Although you may only see grey right now





Walking on the icy road :

You do the penguin walk!

There also tools to help ->



Swedish East India Company



The **Swedish East India Company**, one of Sweden's most successful brands in history, was founded in the year of 1731 in Gothenburg. They traded with China, India and completed 132 voyages in about 80 years.

The replica **Götheborg of Sweden**: the world's largest ocean-going wooden sailing ship was finished in 2003. In October 2005, it sailed to China according to the original ship's route, arrived in July 2006.

Address to visit:

Eriksberg Pir Fyra 2
417 63 Göteborg, Sweden

Lars Magnus Ericsson: 1876 founded L. M. Ericsson



He started to work when he was 14



Ericsson office in Gothenburg (Lindholmen)



One of the first products



One of the recent products

Some information



Walk around city center

Kungsports platsen, Brunnsparken,
Gustav Adolfs torg, Opera house
Kungsportsavenyen, Nordstaden

“Nature” walk

Trädgårdsföreningen
Slottsskogen
Göteborgs botaniska trädgård

Ice Hockey

Scandinavium – SHL: Frölunda-
Växjö, Tue 10 Feb 19.00.

Supermarket

ICA Focus - ~200m to Gothenburg
Towers

Some recommendations

Food within Gothia Towers

- [Twenty four seven](#) – self-service
- [Corner](#)
- [West Coast](#)
- Roof top restaurant
“[Heaven 23](#)” – please book your table

Restaurants

- [Sjöbaren Lorensberg](#) – Seafood
Walking distance from Gothia Towers
- [Humm](#) – Nordic/European
Walking distance
- [Lavette](#) - ”The toast” is recommended
- [Toso](#) – Asian
- [Feskekörka](#) – Fish market with small restaurants
- [Familjen](#) - Modern Swedish / Nordic cuisine 🇸🇪

Cafés (FIKA!)

- [Ahlströms](#) – Oldest confectionary in Gothenburg
- [Brogyllen](#) – artisanal bread and confectionery
- [Husaren](#) – Biggest cinnamon roll in Gbg

The Swedish Semla

- Cardamom-spiced wheat bun which has its top cut off, and is then filled with a mix of milk and almond paste, topped with whipped cream. The cut-off top serves as a lid and is dusted with powdered sugar.
- Traditionally eaten only on the day before Lent (the Christian fasting period), semlor are now eaten on a daily basis by enthusiasts nationwide from Christmas until Easter. They are also called Fat Tuesday-buns.
- This year, Fat Tuesday ('Fettisdagen') falls on **17 February**.
- You find them in every bakery and café (and supermarkets...)
- <https://visitsweden.com/what-to-do/food-drink/swedish-kitchen/swedish-semmla/>



Meeting Access Control

Your badge will be scanned regularly as shown here below
(two areas to cover all the meeting rooms)

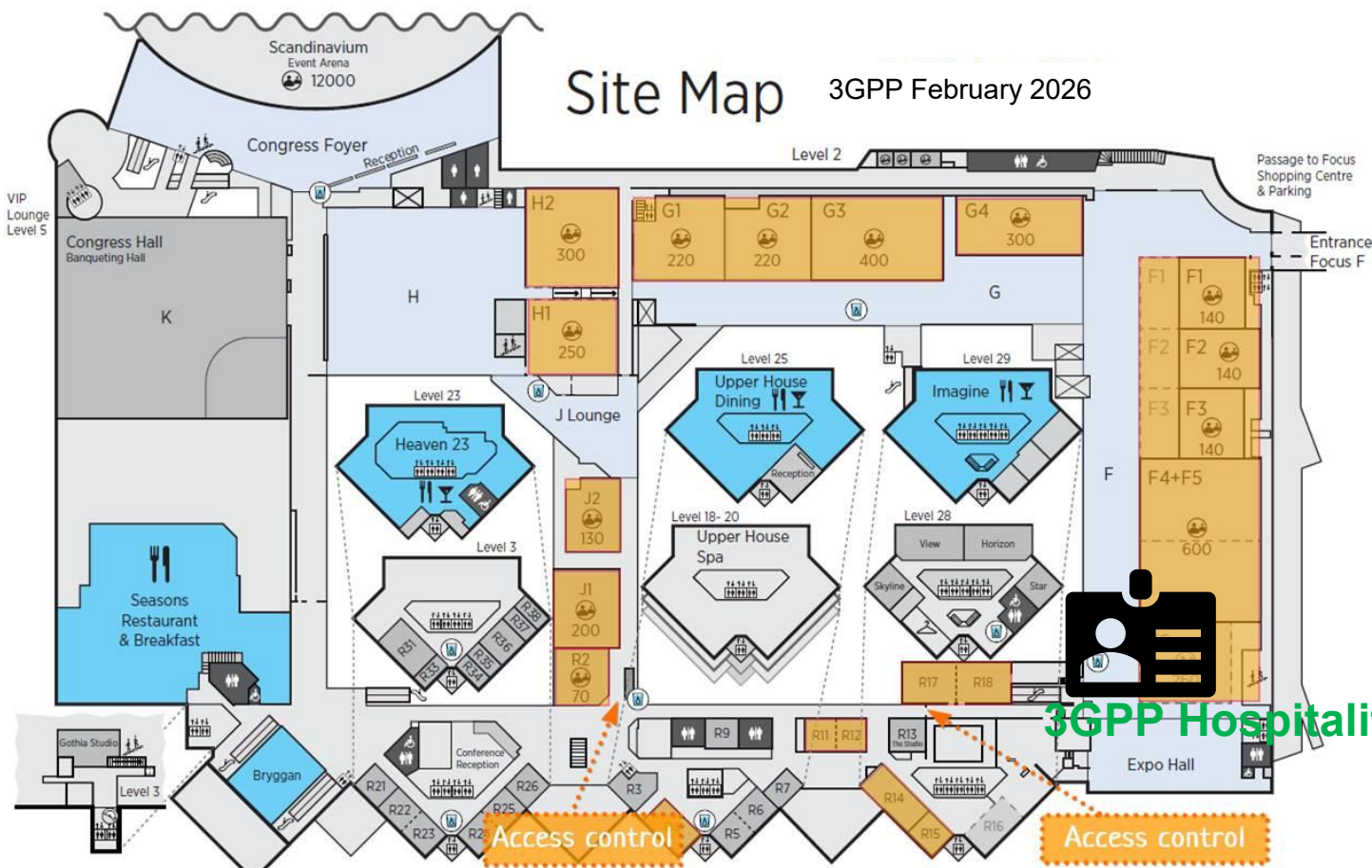

Medical assistance on-site during 3GPP meetings in Goteborg

- ✓ In some emergency situations, every minute counts.
- ✓ Therefore, there will be a medical team dedicated to 3GPP
- ✓ In case of emergency dial **+112 or +46 31 708 8170**
- ✓ **The dedicated medical team to 3GPP** will be available from **08:00am to 20:00 (except on Friday PM 17:00)** in **Gothia Towers**.

Paramedic contact +46 31 708 8170

Meeting Information

Coffee breaks served at:

10:30 & 16:30 (except on Friday PM)

ETSI 3GPP team on-site:

Emmanuelle Wurffel emmanuelle.wurffel@etsi.org

& Aldric Hiegel (IT) aldric.hiegel@etsi.org

Meeting Access Control

To Process your badge

Registration & Badge at the 3GPP Hospitality desk

Please register on the 3GPP Portal (same process as usual)

The confirmation email will contain the usual token as well as a QR code

Delegates already registered do not need to register again

***While entering the meeting venue please make sure that you have your QR code available (either on paper or on your mobile phone)**

*Please scan your QR code on the self-printing desk.

*Your badge will be printed (one badge for all the groups)

Please wear your badge all week

***to be done only the first day**

Opening hours: 07:30-20:00

Site Map

3GPP RAN WGs, 9-13 Feb 2026

VIP Lounge
Level 5

Congress Hall
Banqueting Hall

K

Seasons
Restaurant
& Breakfast

Gothia Studio

Bryggan

Entrance
No. 8

Scandinavian
Event Arena
12000

Congress Foyer

H

H2
300

H1
250

J Lounge

Level 23

Heaven 23

Level 3

J2
130

J1
200

R2
70

Level 18-20

Upper House
Spa

Level 25

Upper House
Dining

Level 29

Imagine

Level 28

View
Horizon

Skyline
Star

R17
R18

R9
R11
R12
R13
R14
R15
R16

R3
R4
R5
R6
R7

R21
R22
R23
R24
R25
R26

R31
R32
R33
R34
R35
R36
R37
R38

R39
R40
R41
R42
R43
R44
R45
R46
R47
R48
R49
R50

R51
R52
R53
R54
R55
R56
R57
R58
R59
R60

R61
R62
R63
R64
R65
R66
R67
R68
R69
R70

R71
R72
R73
R74
R75
R76
R77
R78
R79
R80

R81
R82
R83
R84
R85
R86
R87
R88
R89
R90

R91
R92
R93
R94
R95
R96
R97
R98
R99
R100

R101
R102
R103
R104
R105
R106
R107
R108
R109
R110

R111
R112
R113
R114
R115
R116
R117
R118
R119
R120

R121
R122
R123
R124
R125
R126
R127
R128
R129
R130

R131
R132
R133
R134
R135
R136
R137
R138
R139
R140

R141
R142
R143
R144
R145
R146
R147
R148
R149
R150

R151
R152
R153
R154
R155
R156
R157
R158
R159
R160

R161
R162
R163
R164
R165
R166
R167
R168
R169
R170

R171
R172
R173
R174
R175
R176
R177
R178
R179
R180

R181
R182
R183
R184
R185
R186
R187
R188
R189
R190

R191
R192
R193
R194
R195
R196
R197
R198
R199
R200

R201
R202
R203
R204
R205
R206
R207
R208
R209
R210

R211
R212
R213
R214
R215
R216
R217
R218
R219
R220

R221
R222
R223
R224
R225
R226
R227
R228
R229
R230

R231
R232
R233
R234
R235
R236
R237
R238
R239
R240

R241
R242
R243
R244
R245
R246
R247
R248
R249
R250

R251
R252
R253
R254
R255
R256
R257
R258
R259
R260

R261
R262
R263
R264
R265
R266
R267
R268
R269
R270

R271
R272
R273
R274
R275
R276
R277
R278
R279
R280

R281
R282
R283
R284
R285
R286
R287
R288
R289
R290

R291
R292
R293
R294
R295
R296
R297
R298
R299
R300

R301
R302
R303
R304
R305
R306
R307
R308
R309
R310

R311
R312
R313
R314
R315
R316
R317
R318
R319
R320

R321
R322
R323
R324
R325
R326
R327
R328
R329
R330

R331
R332
R333
R334
R335
R336
R337
R338
R339
R340

R341
R342
R343
R344
R345
R346
R347
R348
R349
R350

R351
R352
R353
R354
R355
R356
R357
R358
R359
R360

R361
R362
R363
R364
R365
R366
R367
R368
R369
R370

R371
R372
R373
R374
R375
R376
R377
R378
R379
R380

R381
R382
R383
R384
R385
R386
R387
R388
R389
R390

R391
R392
R393
R394
R395
R396
R397
R398
R399
R400

R401
R402
R403
R404
R405
R406
R407
R408
R409
R410

R411
R412
R413
R414
R415
R416
R417
R418
R419
R420

R421
R422
R423
R424
R425
R426
R427
R428
R429
R430

R431
R432
R433
R434
R435
R436
R437
R438
R439
R440

R441
R442
R443
R444
R445
R446
R447
R448
R449
R450

R451
R452
R453
R454
R455
R456
R457
R458
R459
R460

R461
R462
R463
R464
R465
R466
R467
R468
R469
R470

R471
R472
R473
R474
R475
R476
R477
R478
R479
R480

R481
R482
R483
R484
R485
R486
R487
R488
R489
R490

R491
R492
R493
R494
R495
R496
R497
R498
R499
R500

R501
R502
R503
R504
R505
R506
R507
R508
R509
R510

R511
R512
R513
R514
R515
R516
R517
R518
R519
R520

R521
R522
R523
R524
R525
R526
R527
R528
R529
R530

R531
R532
R533
R534
R535
R536
R537
R538
R539
R540

R541
R542
R543
R544
R545
R546
R547
R548
R549
R550

R551
R552
R553
R554
R555
R556
R557
R558
R559
R560

R561
R562
R563
R564
R565
R566
R567
R568
R569
R570

R571
R572
R573
R574
R575
R576
R577
R578
R579
R580

R581
R582
R583
R584
R585
R586
R587
R588
R589
R590

R591
R592
R593
R594
R595
R596
R597
R598
R599
R600

R601
R602
R603
R604
R605
R606
R607
R608
R609
R610

R611
R612
R613
R614
R615
R616
R617
R618
R619
R620

R621
R622
R623
R624
R625
R626
R627
R628
R629
R630

R631
R632
R633
R634
R635
R636
R637
R638
R639
R640

R641
R642
R643
R644
R645
R646
R647
R648
R649
R650

R651
R652
R653
R654
R655
R656
R657
R658
R659
R660

R661
R662
R663
R664
R665
R666
R667
R668
R669
R670

R671
R672
R673
R674
R675
R676
R677
R678
R679
R680

R681
R682
R683
R684
R685
R686
R687
R688
R689
R690

R691
R692
R693
R694
R695
R696
R697
R698
R699
R700

R701
R702
R703
R704
R705
R706
R707
R708
R709
R710

R711
R712
R713
R714
R715
R716
R717
R718
R719
R720

R721
R722
R723
R724
R725
R726
R727
R728
R729
R730

R731
R732
R733
R734
R735
R736
R737
R738
R739
R740

R741
R742
R743
R744
R745
R746
R747
R748
R749
R750

R751
R752
R753
R754
R755
R756
R757
R758
R759
R760

R761
R762
R763
R764
R765
R766
R767
R768
R769
R770

R771
R772
R773
R774
R775
R776
R777
R778
R779
R780

R781
R782
R783
R784
R785
R786
R787
R788
R789
R790

R791
R792
R793
R794
R795
R796
R797
R798
R799
R800

R801
R802
R803
R804
R805
R806
R807
R808
R809
R810

R811
R812
R813
R814
R815
R816
R817
R818
R819
R820

R821
R822
R823
R824
R825
R826
R827
R828
R829
R830

R831
R832
R833
R834
R835
R836
R837
R838
R839
R840

R841
R842
R843
R844
R845
R846
R847
R848
R849
R850

R851
R852
R853
R854
R855
R856
R857
R858
R859
R860

R861
R862
R863
R864
R865
R866
R867
R868
R869
R870

R871
R872
R873
R874
R875
R876
R877
R878
R879
R880

R881
R882
R883
R884
R885
R886
R887
R888
R889
R890

R891
R892
R893
R894
R895
R896
R897
R898
R899
R900

R901
R902
R903
R904
R905
R906
R907
R908
R909
R910

R911
R912
R913
R914
R915
R916
R917
R918
R919
R920

R921
R922
R923
R924
R925
R926
R927
R928
R929
R930

R931
R932
R933
R934
R935
R936
R937
R938
R939
R940

R941
R942
R943
R944
R945
R946
R947
R948
R949
R950

R951
R952
R953
R954
R955
R956
R957
R958
R959
R960

R961
R962
R963
R964
R965
R966
R967
R968
R969
R970

R971
R972
R973
R974
R975
R976
R977
R978
R979
R980

R981
R982
R983
R984
R985
R986
R987
R988
R989
R990

R991
R992
R993
R994
R995
R996
R997
R998
R999
R1000

R1001
R1002
R1003
R1004
R1005
R1006
R1007
R1008
R1009
R1010

R1011
R1012
R1013
R1014
R1015
R1016
R1017
R1018
R1019
R1020

R1021
R1022
R1023
R1024
R1025
R1026
R1027
R1028
R1029
R1030

R1031
R1032
R1033
R1034
R1035
R1036
R1037
R1038
R1039
R1040

R1041
R1042
R1043
R1044
R1045
R1046
R1047
R1048
R1049
R1050

R1051
R1052
R1053
R1054
R1055
R1056
R1057
R1058
R1059
R1060

R1061
R1062
R1063
R1064
R1065
R1066
R1067
R1068
R1069
R1070

R1071
R1072
R1073
R1074
R1075
R1076
R1077
R1078
R1079
R1080

R1081
R1082
R1083
R1084
R1085
R1086
R1087
R1088
R1089
R1090

R1091
R1092
R1093
R1094
R1095
R1096
R1097
R1098
R1099
R1100

R1101
R1102
R1103
R1104
R1105
R1106
R1107
R1108
R1109
R1110

R1111
R1112
R1113
R1114
R1115
R1116
R1117
R1118
R1119
R1120

R1121
R1122
R1123
R1124
R1125
R1126
R1127
R1128
R1129
R1130

R1131
R1132
R1133
R1134
R1135
R1136
R1137
R1138
R1139
R1140

R1141
R1142
R1143
R1144
R1145
R1146
R1147
R1148
R1149
R1150

R1151
R1152
R1153
R1154
R1155
R1156
R1157
R1158
R1159
R1160

R1161
R1162
R1163
R1164
R1165
R1166
R1167
R1168
R1169
R1170

R1171
R1172
R1173
R1174
R1175
R1176
R1177
R1178
R1179
R1180

R1181
R1182
R1183
R1184
R1185
R1186
R1187
R1188
R1189
R1190

R1191
R1192
R1193
R1194
R1195
R1196
R1197
R1198
R1199
R1200

R1201
R1202
R1203
R1204
R1205
R1206
R1207
R1208
R1209

Opening hours: 07:30-20:00

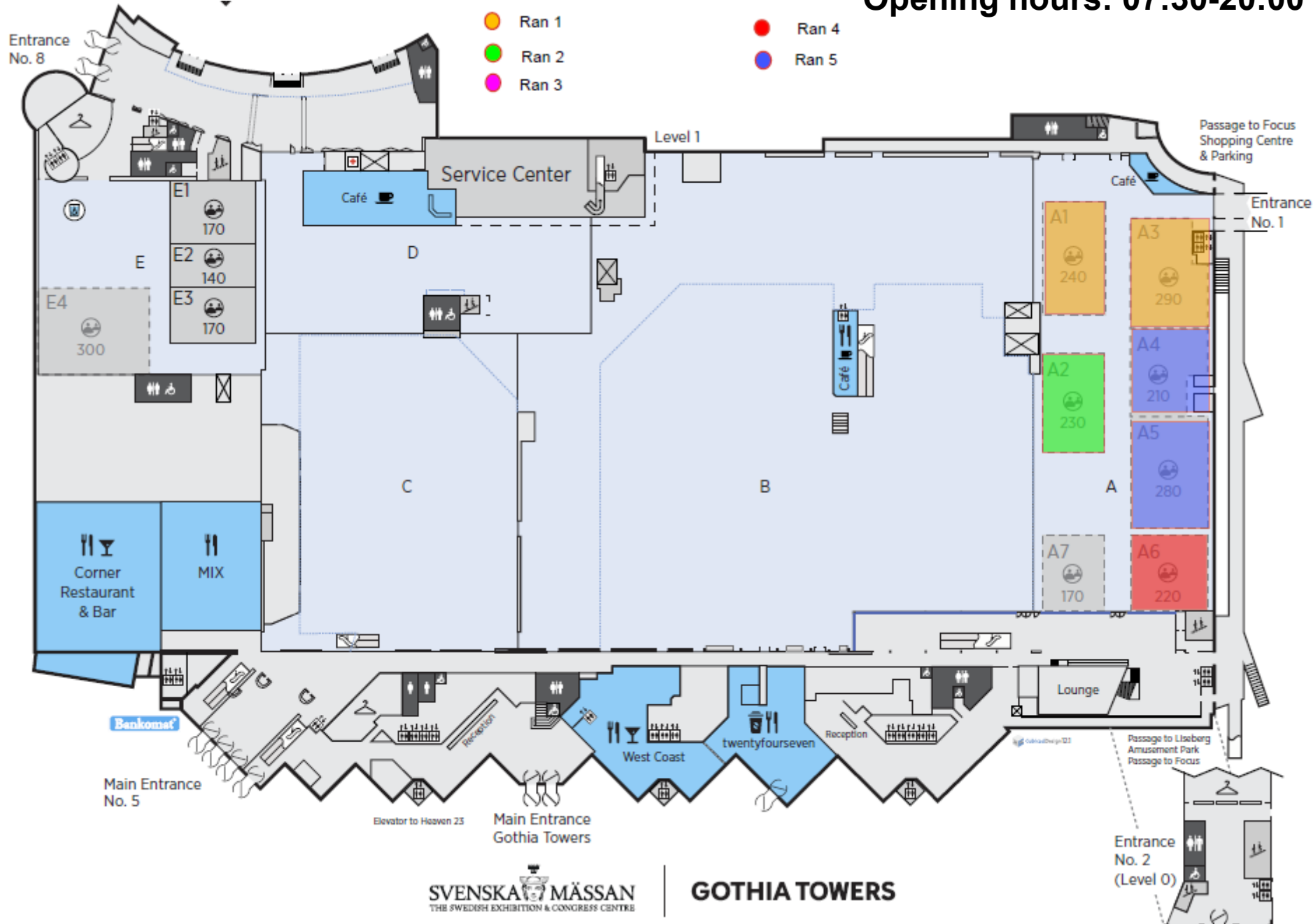

RAN meeting rooms

	Days	Plenary	Title for signage	Break out	Capacity	Meeting room	Floor
RAN1	All week	X	RAN1_Main		500	F1+F2+3F	Level 2
	All week		RAN1_Brk1	x	150	A1	Level 1
	All week		RAN1_Brk2	X	150	A3	Level 1
	All week		RAN1_Off2	X	60	J2	Level 2
	All week		RAN1_Off1	X	100	J1	Level 2
RAN2	All week	X	RAN2 Main		350	F4 + F5	Level 2
	All week		RAN2 BO3	X	50	R17+R18	Level 2
	All week		RAN2 BO1	X	150	A2	Level 1
	All week		RAN2 BO2	X	100	F6	Level 2
RAN3	All week	X	RAN3 Main		144	H1	Level 2
	All week		RAN3 break out	X	50	R2	Level 2
RAN4	All week	X	RAN4 Main		350	G2+G3	Level 2
	All week		RAN4 RRM	X	100	G1	Level 2
	All week		RAN4 BDaT	X	150	G4	Level 2
	All week		RAN4 Adhoc	X	80	A6	Level 1
RAN5	All week	X	RAN5 Main		150	A5	Level 1
	All week		RAN5 break out	X	80	A4	Level 1
Coffee break	All week (except Friday PM)	Level 1 & Level 2					
3GPP hospitality desk	All week	Level 2					

3GPP Wireless LAN

Wireless LAN:

SSID: 3GPPWIFI

Password: 3GPP3GPPM (CAPITAL LETTERS!)

IP address: 10.10.10.10

--> USUAL SETTING



Have a great time in Gothenburg!

[RAN WGs Goteborg](#)



E3MAG@etsi.org