

CCSA and CF3 has the pleasure of welcoming you to

3GPP RAN#109, SA#109 and CT#109

Beijing, China, 15-19 September, 2025

hosted by Chinese Friends of 3GPP (CF3)



SAMSUNG

CAICT 中国信通院



oppo



美国高通公司
Qualcomm®

vivo

ZTE



HONOR

Lenovo 联想

Beijing' s Location in China Map



Beijing' s Attractions



Tian' anmen Square (天安门广场)

Tian'anmen Square, located on East Chang'an Avenue in Dongcheng District of Beijing, has undergone many revisions and changes, and finally formed a large square with a length of 880 meters from north to south, a width of 500 meters from east to west, and an area of 440,000 square meters, which is the largest urban square in the world. The central axis of Tian'anmen Square is in the middle, and the two wings are symmetrical, which can accommodate 1 million people to hold a grand rally. Along the central axis of Beijing, the flagpole, the Monument to the People's Heroes, the Mausoleum of Mao Zedong, and the Zhengyangmen City Gate stand one after another from north to south in the square.

Beijing' s Attractions



The Great Wall at Badaling (八达岭长城)

- **The Great Wall at Badaling** is located at the northern entrance of the ancient pass of Jundu Mountain in Yanqing District, Beijing. It is an important part of the Great Wall, a Great defensive project in ancient China, and a pass of the Ming Great Wall. It is one of the best preserved and most representative sections of the Ming Great Wall, known as one of the "Nine Passes of the World," and is a must-visit destination in Beijing. The Great Wall at Badaling is located in a strategic position, with a commanding height. The wall is tall and strong, with a dense network of watchtowers, showcasing the outstanding achievements of ancient Chinese architectural art and the wisdom of the working people. In 1987, the Great Wall at Badaling, as an important part of the Great Wall, was listed in the World Cultural Heritage List.

Beijing' s Attractions



The Palace Museum (故宫博物院)

- **The Palace Museum**, located in the center of Beijing, formerly known as the Forbidden City, is the royal palace of the Ming and Qing dynasties. It is now the largest ancient cultural and art museum in China. It was built in the fourth year of Yongle of the Ming Dynasty (1406 AD) and completed in the eighteenth year of Yongle (1420 AD), passing through 24 emperors of the Ming and Qing Dynasties. The architectural style integrates the essence of ancient Chinese palace architecture, with yellow glazed tiles on the roof, red palace walls, and white base as the main features, decorated with exquisite wood carvings, stone carvings, and colorful paintings, reflecting the highest achievement of ancient Chinese architectural art.

Beijing' s Attractions



The Summer Palace (颐和园)

- **The Summer Palace**, located in the western suburbs of Beijing, is a royal garden of the Qing Dynasty in China. It was originally known as Qingyi Garden and was built in 1750. It was rebuilt in 1888, after which it was renamed the Summer Palace. It is the most complete royal palace and garden, known as the "Royal Garden Museum", and was listed in the World Cultural Heritage List in 1998.

Beijing' s Attractions

The Temple of Heaven (天坛)

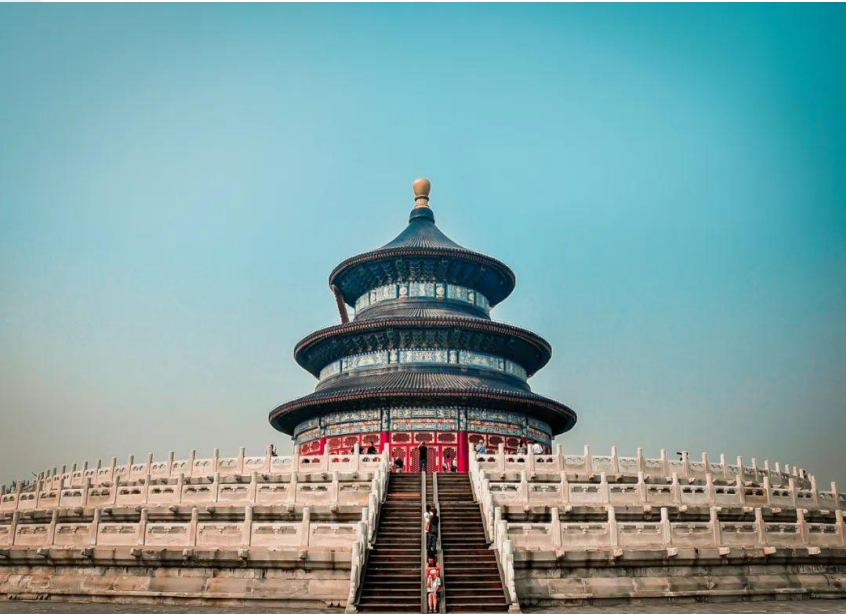

- **The Temple of Heaven** is located on the east side of Yongdingmen Street in the Dongcheng District, Beijing. It was the place where the emperors of the Ming and Qing dynasties worshipped Heaven and prayed for bumper crops. The northern part of the outer surrounding wall is semi-circular in shape, while the southern part is square, a pattern symbolic of the ancient belief that Heaven was round and the earth square.
- As a masterpiece of the Ming and Qing architectural art and a precious example of China's ancient architecture, the Temple of Heaven is the largest architectural complex for worshipping Heaven in the world. In 1998, it was listed in the World Cultural Heritage List.

Beijing' s Attractions



Bird's Nest, Water Cube (鸟巢、水立方)

- **The Bird's Nest** is a national stadium built for the 2008 Beijing Olympic Games, located in the Beijing Olympic Park. Its design is inspired by the traditional Chinese culture of bird nests, with a unique architectural shape and a large amount of steel structure, forming a huge and interlaced network structure.
- **The Water Cube** is the main swimming pool built for the 2008 Summer Olympics, located on the south side of the Bird's Nest. The exterior design of the Water Cube is inspired by water bubbles and adopts a unique membrane structure, which has good light transmission and aesthetics.

Local Foods



Beijing Roast Duck (北京烤鸭)



Mutton Hotpot (铜锅涮肉)



Noodles with Soybean Paste (炸酱面)



Traditional Snacks of Old Beijing (老北京特色小吃)

Hotel



China World Hotel Beijing

- China World Hotel Beijing is ideally located in Beijing's central business district (CBD) and is attached to China World Mall. Guests have direct access from the hotel to the Guomao subway lines 1 and 10 interchange station. It is also only a 35-minute drive from Beijing Capital International Airport and a 50-60-minute drive from Beijing Daxing International Airport.

Please take me to China World Hotel Beijing,
Address: NO.1 Jianguomenwai Avenue, Beijing China
Tel: 86 10 6505 2266

请送我去中国大饭店
地址：中国北京市朝阳区建国门外大街1号
电话：86 10 6505 2266

Hotel Location

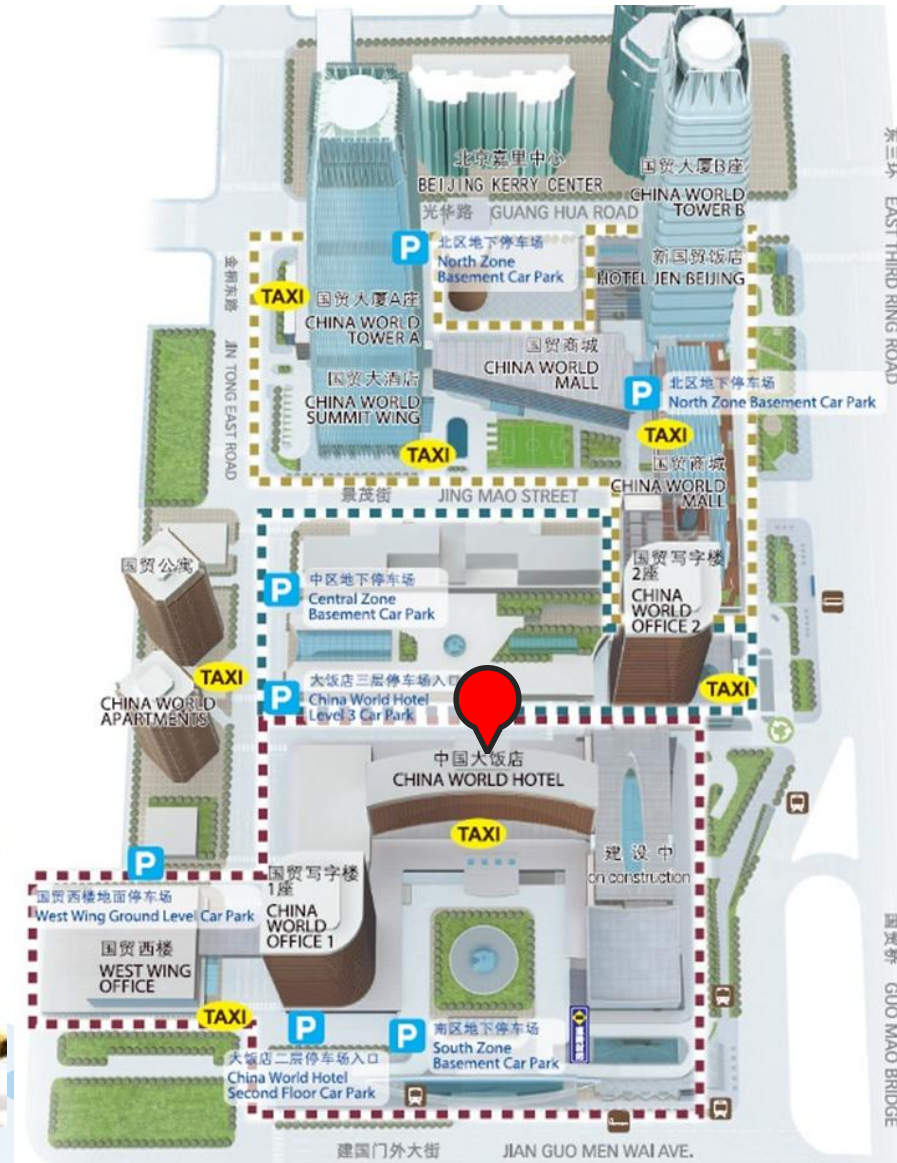
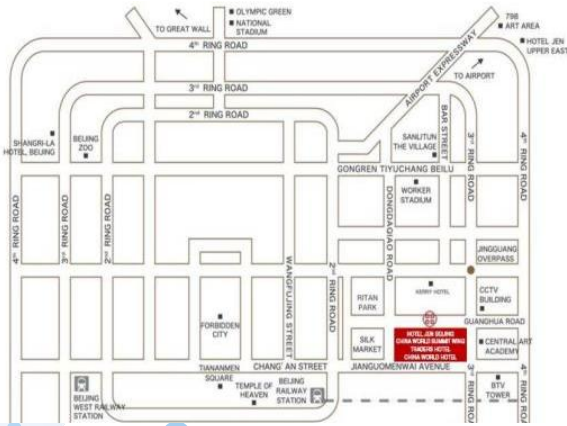

DESTINATION BEIJING

- Beijing Financial Street (15-20 minutes)
- Tian'anmen Square (10-15 minutes)
- The Forbidden City (15-20 minutes)
- The Temple of Heaven (20-25 minutes)
- The Sanlitun Street (10-15 minutes)
- The Wangfujing Street (10-15 minutes)
- Silk Market (5-6 minutes)
- The Hutongs (15-20 minutes)
- The Universal Beijing (22-25 minutes)
- The Summer Palace (35-40 minutes)
- The Great Wall (1-1.5 hours)

Meeting Room Allocation-MON

Date	Time	Event	Function room/Capacity
15 th Sep (MON)	9:00-19:00	RAN#109-Main	Conference Hall AB (1F)/500
	13:00-19:00	RAN#109-1	Conference Hall C (1F)/150
	9:00-19:00	CT#109-Main	Grand Ballroom AB (1F)/100
	10:30-11:00/ 15:30-16:00	Coffee Break	Grand Ballroom/Conference Hall Foyer

Meeting Room Allocation-TUE

Date	Time	Event	Function room/Capacity
16 th Sep (TUE)	9:00-19:00	RAN#109-Main	Conference Hall AB (1F)/500
	9:00-19:00	RAN#109-1	Conference Hall C (1F)/150
	13:00-19:00	SA#109-Main	Grand Ballroom CD (1F)/300
	9:00-19:00	CT#109-Main	Grand Ballroom AB (1F)/100
	10:30-11:00/ 15:30-16:00	Coffee Break	Grand Ballroom/Conference Hall Foyer

Meeting Room Allocation-WED

Date	Time	Event	Function room/Capacity
17 th Sep (WED)	9:00-19:00	RAN#109-Main	Conference Hall AB (1F)/500
	9:00-19:00	RAN#109-1	Conference Hall C (1F)/150
	9:00-19:00	SA#109-Main	Grand Ballroom CD (1F)/300
	10:30-11:00/ 15:30-16:00	Coffee Break	Grand Ballroom/Conference Hall Foyer

Meeting Room Allocation-THU

Date	Time	Event	Function room/Capacity
18 th Sep (THU)	9:00-19:00	RAN#109-Main	Conference Hall AB (1F)/500
	9:00-19:00	RAN#109-1	Conference Hall C (1F)/150
	9:00-19:00	SA#109-Main	Grand Ballroom CD (1F)/300
	10:30-11:00/ 15:30-16:00	Coffee Break	Grand Ballroom/Conference Hall Foyer

Meeting Room Allocation-FRI

Date	Time	Event	Function room/Capacity
19 th Sep (FRI)	9:00-19:00	SA#109-Main	Grand Ballroom CD (1F)/300
	10:30-11:00	Coffee Break	Grand Ballroom Foyer

Meeting Room Map

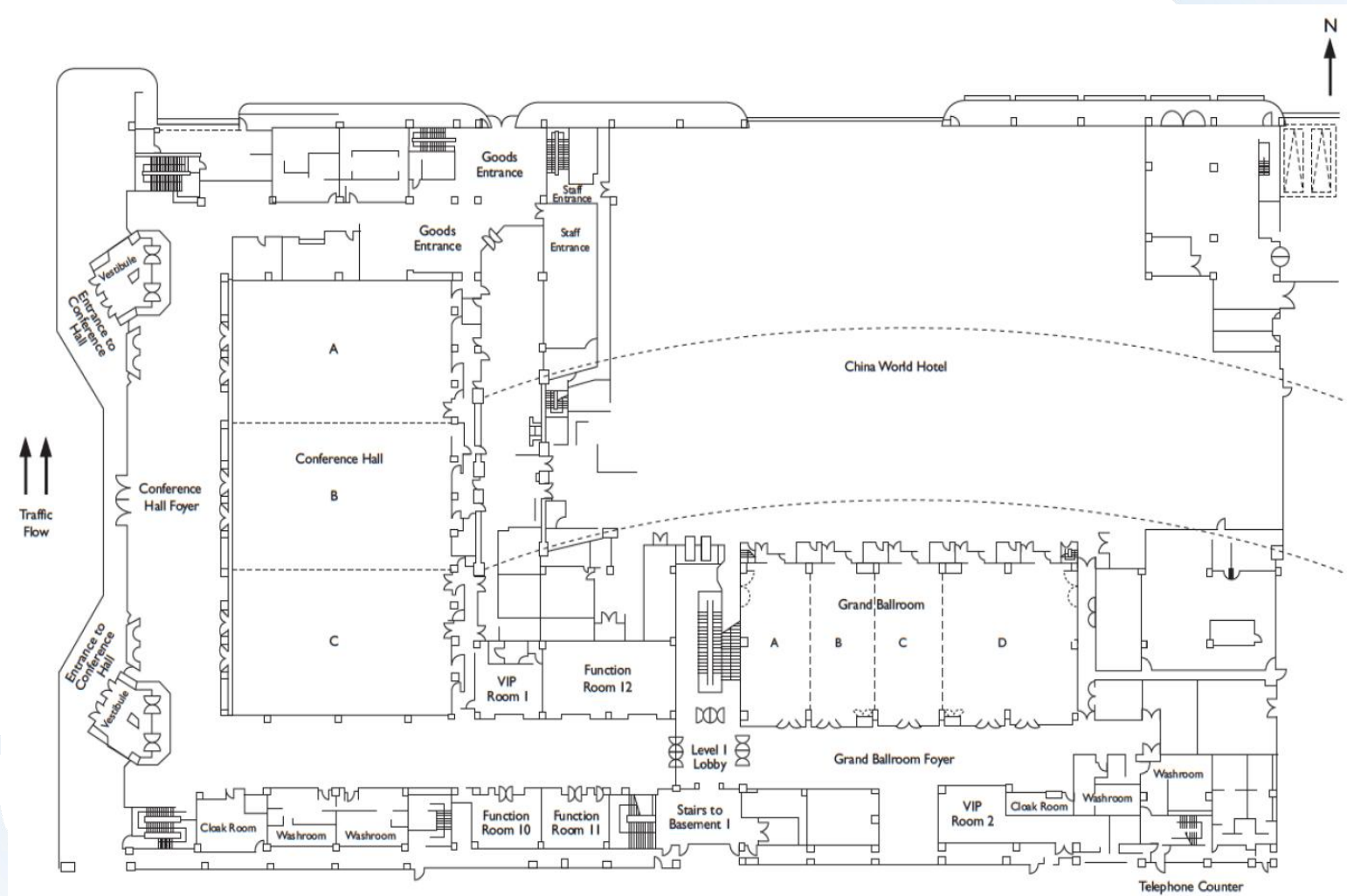

1st floor

Hotel Gourmet Restaurant

- Scene a Café Located at Level 2
- For 3GPP guest will offer 20% discount at Scene a Cafe Restaurant for the buffet meal, please show your badge upon to the waiter
 - Breakfast Buffet
 - Monday to Sunday 06:30 - 10:30
 - Lunch Buffet CNY398 net per person
 - Monday to Sunday 11:30 – 14:00
 - Dinner Buffet CNY398 net per person
 - Wednesday to Saturday 17:30-21:00
 - A la carte dinner menu
 - Sunday to Tuesday 17:30-21:00
- All-day dining with a dynamic open kitchen concept, features local dishes and Asian favorites.



Hotel Gourmet Restaurant

- Summer Palace located at Level 2
- For 3GPP guest will offer 15% discount at Summer Palace Restaurant, please show your badge upon to the waiter
- Private Dining Room:6 (Accepts reservations for 6 or more people)
- Operation Hours:
Lunch 11:30 - 14:30 (A-la-carte menu & set menu)
Dinner 17:30 - 21:00 (A-la-carte menu & set menu)
- Combine classic Cantonese with creative Huaiyang cuisine offering a signature selection of Chinese premium teas and culinary condiments.
- Lunch set menu for Two CNY664 net per set (Reservations must be made 1h in advance.)



GIADA Garden

- GIADA Garden Italian Restaurant is located on the 3rd floor of China World Hotel, covering a total area of 645 square meters, including an aerial garden and indoor dining area. The interior design of the restaurant follows GIADA's brand concept, with a simple design, modern style, and elegant heritage, making GIADA Garden a masterpiece of “art.”.

- Located at Level 3
- Operation Hours: Monday to Saturday

Dinner 17:30 – 23:30 (A-la-carte menu & set menu)

- Dinner set menu for one CNY 1,846net per set



Lobby Lounge

- With a daily variety of international music, it is an ideal venue for business meetings, gathering with friends or an elegant pre or after dinner cocktail.
- Located at Level 2
- Operation Hours 09:00 - 23:00



Dining out——Nanmen Shuangrou(China World Mall Store) 南门涮肉 (国贸商城店)



Name: Nanmen Shuangrou (China World Mall Store)

Address: SL5009 - 5011, 5th Floor, South Mall, China World Trade Center,
No.1, Jianguomenwai Street

Opening hours:
10:30am-22:30pm

(Beijing cuisine)

Distance: 750 meters, 10 minutes walk



Dining out——Xihe Yayuan Beijing Roast Duck (China World Mall Store) 羲和雅苑·北京烤鸭(国贸商城店)



Name: Xihe Yayuan Beijing Roast Duck (China World Mall Store)

Address: SB127B & 128, 1st Floor, West Building, South District, Phase 1, China World Mall, No.1, Jianguomenwai Street

Opening hours:
11:00am-21:30pm

(Beijing cuisine)

Distance: 565 meters, 7 minutes walk

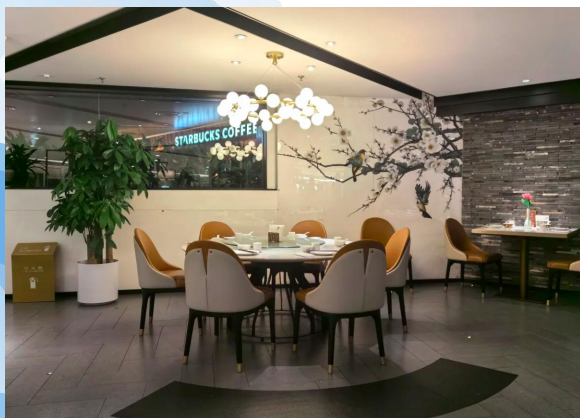

Dining out——Guanye Street Macao Hot Pot (China World Mall Store) 官也街澳门火锅(国贸商城店)



Name: Guanye Street Macao Hot Pot (China World Mall Store)

Location: NL7001, 7th Floor, North District, China World Mall, No.1, Jianguomenwai Street

Opening hours:
11:00am-23:00pm

(Macau cuisine)

Distance: 733 meters, 11 minutes walk



Dining out——Qing Shui Ting Hubei Cuisine (China World Mall Store)

清水亭湖北菜(国贸商城店)



Name: Qing Shui Ting Hubei Cuisine (China World Mall Store)

Address: SL4011, 4th Floor, South Mall, China World Trade Center, No.1, Jianguomenwai Street

Opening hours:

11:00am-16:00pm

17:00pm-21:30pm

(Hubei cuisine)

Distance: 534m, 8 minutes walk



How to Use Alipay and WeChat Pay

Alipay and WeChat Pay are two important payment methods in China. Learning how to use them will make your travel to China much easier. Click on the PDF link below to learn more.



[Alipay Use Introduction.pdf](#)



[WeChat Pay Use Introduction.pdf](#)

Meeting Staff

If you need any assistance during your stay, you may go to staff at the Information desk outside the meeting room. For any emergency please contact us at:

CCSA Mr. QI Xu (+86-13466724696)

CCSA Mr. BAI Ruixiao (+86-15501150226)

Emergency Assistance



- If the matter is NOT an emergency, dial **“9+139-1175-9397”** from any hotel phone to ask Hotel Duty Manager to help.
- In case of emergency please dial **120**.
- AED emergency equipment storage location:
1) 2F Lobby Lounge 2) B2F Aerobics





Have a successful meeting and
enjoy your stay in Beijing!